



## **16" Wall Fan**

### **Operating Instructions**

**PLEASE READ THESE INSTRUCTIONS CAREFULLY BEFORE USE AND KEEP FOR FUTURE REFERENCE**

# IMPORTANT PRODUCT INFORMATION

## READ IMMEDIATELY

### SAFETY FIRST!

Failure to observe the following safety warnings may result in serious injury or death. Use all Hydro Crunch™ products only as directed. Failure to observe these safety warnings will result in a waiver of any and all liability on the part of Hydro Crunch™ its manufacturer, and resellers, and will void all warranties to the extent permitted by law.

## WARNINGS AND INSTRUCTIONS FOR USE:

- DO NOT use in a bathroom or outdoors.
- DO NOT allow the fan or its lead to be submerged in water.
- DO NOT insert objects through the grilles on the fan.
- DO NOT use the fan near an open flame, cooking or heating appliance.
- DO NOT use near curtains or other loose fabrics.
- ALWAYS ensure the fan unit is properly connected to the wall and the power lead properly connected.
- ALWAYS unplug the fan before cleaning or when removing from the wall.
- ALWAYS ensure that the fan is left out of reach of children or pets.

**IMPORTANT**--If the mains lead of this appliance becomes damaged then it must be replaced by the manufacturer's service agent, or a suitably qualified person, using the same rated cable in order to avoid a hazard.

## Assembly Instructions

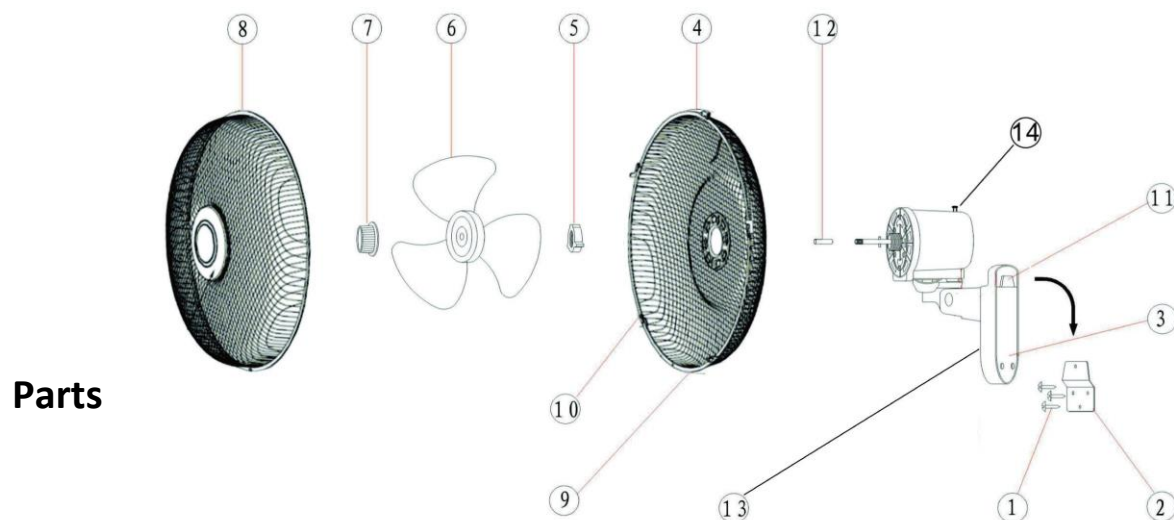

- 1) Screws
- 2) Hanging Bracket
- 3) Motor control Assembly
- 4) Rear guard
- 5) Rear guard securing ring
- 6) Fan blade
- 7) Fan blade securing cap nut
- 8) Front Guard
- 9) Safety Screw
- 10) Swivel brackets
- 11) Bracket fix
- 12) Plastic protector
- 13) Control panel

- 1) Mount the hanging bracket (2) on the wall with the screws (1) provided (fig 1.)
- 2) Hang the motor and control assembly (3) with the bracket (11) onto the hanging Bracket (fig 2.)

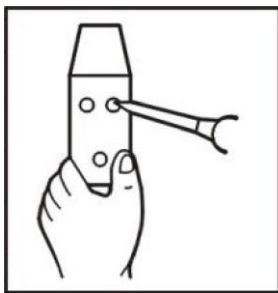

(Fig 1)

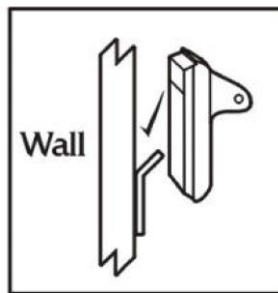

(Fig 2)

- 3) Remove the plastic protector (12)

- 4) Looses the rear guard securing ring (5) from the motor housing assembly.
- 5) Position the rear guard (4) firmly to the motor housing assembly and fasten by turning the rear guard securing ring (5) clockwise tightly.
- 6) Push the fan blade (6) along the motor shaft.
- 7) Fasten securely using the fan blade securing unit nut (7) with the spinner by turning counterclockwise.
- 8) Mount the front guard (8) to the rear guard by positioning the hook on the front guard over the top of the rear guard. Secure the two grilles with clips and screw attachment to the grill.

## **Using Your Fan**

- 1) To operate the fan pull left cord either 1, 2, or 3 times to select the speed required.  
LOW/ MEDIUM/HIGH.
- 2) To operate the oscillation feature pull the right cord once to activate and again to stop.

## **Cleaning**

- 1) Switch the fan off and disconnect from the power. Ensure that the blade has come to a complete stop before commencing cleaning.
- 2) Wipe off excess dust with a lint free cloth. To ensure adequate air circulation to the motor, keep the vents at the rear of the motor housing free from dust. The brush attachments on your vacuum cleaner can be used to do this.
- 3) Do not immerse the body of the fan in water and ensure all external connection switches and sockets are kept dry.
- 4) Chemicals, detergents or any abrasive cleaning powder pads or polish of any kind must not be used as they can damage the fan.

This appliance is not intended for use by persons including children with reduced physical sensory, or mental capabilities, or lack of experience and knowledge unless they have been given supervision or instructions concerning use of the appliance by a person responsible for their safety.

***THERE ARE NO USER SERVICEABLE PARTS INSIDE AND THE CASING SHOULD NOT BE OPENED  
BY AN UNQUALIFIED PERSON***

### **Electrical Connection**

Ensure your supply is rated at 120V and 60Hz before operating the appliance.

## 1 Year Limited Warranty Service

If the product will not work after you have read the troubleshooting guide and practiced the troubleshooting options, you are advised to return the Hydro Crunch™ product to the retailer you purchased it from. The dealer will be able to examine the product and test its components. If they are not able to repair the product, they will return it to us for examination and repair/replacement. Do not attempt to repair any product on your own, as serious injury or death may result. If the retailer is not able to help you and the product is still under manufacturer's warranty, you may contact us for technical support. In some cases, you will be issued an RMA# (return merchandise authorization number) to return the unit for factory repair. Complete the warranty form below and return the product with all original packaging, your receipt of purchase, and a valid RMA# to the address below. Please pack and ship the product in its original packaging. If it is damaged in shipment we cannot be responsible and the warranty may be voided. Once we receive RMA package, it will be repaired or replaced and shipped back to you. Please note if an additional warranty was purchased and include the extended warranty sales receipt with your return.

### RETURN FORM

**Include the following if returning:**

- ✓ Proof of purchase
- ✓ This completed form
- ✓ RMA# on the outside of the box
- ✓ Extended warranty receipt

**Return Merchandise Authorization Number (Required):** \_\_\_\_\_

**Contact Name:** \_\_\_\_\_

**Address:** \_\_\_\_\_

**Phone #:** \_\_\_\_\_

**Email Address:** \_\_\_\_\_

**Please give a brief description of your technical issue:** \_\_\_\_\_

\_\_\_\_\_

\_\_\_\_\_

\_\_\_\_\_

### SEND TO:

Hydro Crunch  
17128 Colima Road Suite 510  
Hacienda Heights, CA 91745  
714-516-8176